

LEAD FREE PART NUMBER

SHELL	A±0.38	B±0.12	C±0.10	D±0.25	E±0.07	PART NUMBER
09	30.81	24.99	16.96	16.79	10.96	D09P24A.PX00LF
15	39.14	33.32	25.18	25.12	19.18	D15P24A.PX00LF
25	53.03	47.04	39.12	38.84	33.12	D25P24A.PX00LF
37	69.32	63.50	55.68	55.30	49.68	D37P24A.PX00LF

Plating: 4 --> flash Au
Plating: 6 --> 0.76 μ Au

PC card drilling dimensions(after plating)
(thickness 1.60±0.20mm)

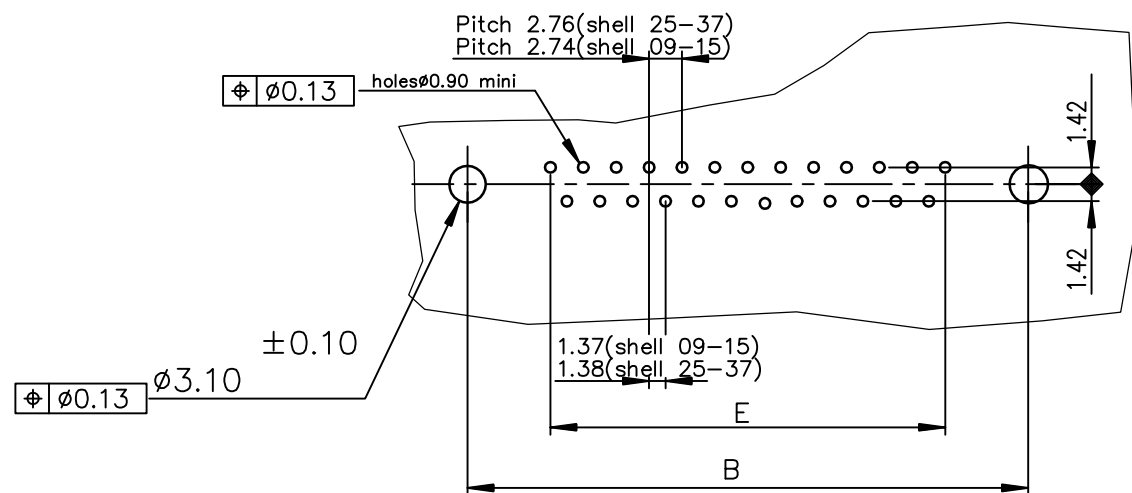

Notes:

1) The nut can protrude above the surface of insulator but maintaining the footprint dimension 6.0±0.15 mm.

GENERAL CHARACTERISTICS AND ROHS INFORMATIONS:
SEE DRAWING C01-8646-0000

mat'l. code		surface		tolerance		projection		product family	
-		ISO 1302 ✓		ISO 406 ISO 1101				D-SUB	
ltr		ecn no		dr		date		title	
H		ELX-I-22878		AB		2015/01/06		MALE CONNECTOR DELTA-D STRAIGHT - SOLDER TYPE	
				angles		linear		scale 2:1	
				0°±2'		.0±.0.1 .00±0.1 .000±0.1		MM	
				dr		LELEON		1992/09/10	
				enr		ALIAS BABU		2015/01/06	
				chr		MITHUN PAUL		2015/01/06	
				app		BIJU K PAUL		2015/01/06	
sheet index		revision sheet		H				dwg no	
		1						sheet 1 of 1	
								size	
								A3	
								type	
								Product Customer Drawing	